

# Application Submittal Checklist

*The following items are required for submittal of the grant application. Please verify and check off that the items have been included in the application packet.*

- 1) Certificate of Good Standing (If the Applicant is an Organization)
- 2) Declaration Statement
- 3) Verify that grant shall be used for a public purpose
- 4) Background and Summary
- 5) Service Summary and Outcomes
- 6) Budget
  - a) Budget request by source of funds ([Link](#))
  - b) Personnel salaries and wages ([Link](#))
  - c) Equipment and motor vehicles ([Link](#))
  - d) Capital project details ([Link](#))
  - e) Government contracts, grants, and grants in aid ([Link](#))
- 7) Experience and Capability
- 8) Personnel: Project Organization and Staffing



AUTHORIZED SIGNATURE

GREGORY DUNNE, PRES. & CEO

PRINT NAME AND TITLE

1/20/2022

DATE

**THE THIRTIETH LEGISLATURE**  
**APPLICATION FOR GRANTS**  
**CHAPTER 42F, HAWAII REVISED STATUTES**

Type of Grant Request:

Operating                       Capital

Legal Name of Requesting Organization or Individual: Dba:

Hawaii Theatre Center

Amount of State Funds Requested: \$ 500,000

Brief Description of Request (Please attach word document to back of page if extra space is needed):

Complete the exterior repair of spalling, repaint all exterior walls, repair existing water damaged frames or window sills.

Amount of Other Funds Available:

State: \$ \_\_\_\_\_

Federal: \$ 651,839

County: \$ \_\_\_\_\_

Private/Other: \$ 250,000

Total amount of State Grants Received in the Past 5 Fiscal Years:

\$ 973,589

Unrestricted Assets:

\$ 9,666,737.04

New Service (Presently Does Not Exist):  Existing Service (Presently in Operation):

Type of Business Entity:

- 501(C)(3) Non Profit Corporation  
 Other Non Profit  
 Other

Mailing Address:

P.O. Box 341

City:

Honolulu

State:

HI

Zip:

96809-0341

Contact Person for Matters Involving this Application

Name:  
Gregory D. Dunn

Title:  
President and Chief Executive Officer

Email:  
gregorydunn@hawaii theatre.com

Phone:  
808-791-1330

Federal Tax ID#:

██████████

State Tax ID#

██████████



Authorized Signature

Gregory D. Dunn, President and CEO

Name and Title

1/20/2022

Date Signed

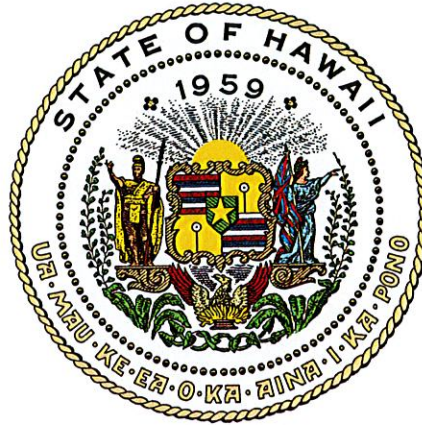

## Department of Commerce and Consumer Affairs

### CERTIFICATE OF GOOD STANDING

I, the undersigned Director of Commerce and Consumer Affairs of the State of Hawaii, do hereby certify that

HAWAII THEATRE CENTER

was incorporated under the laws of Hawaii on 04/27/1984 ; that it is an existing nonprofit corporation; and that, as far as the records of this Department reveal, has complied with all of the provisions of the Hawaii Nonprofit Corporations Act, regulating domestic nonprofit corporations.



IN WITNESS WHEREOF, I have hereunto set my hand and affixed the seal of the Department of Commerce and Consumer Affairs, at Honolulu, Hawaii.

Dated: January 20, 2022

Director of Commerce and Consumer Affairs



**DECLARATION STATEMENT OF  
APPLICANTS FOR GRANTS PURSUANT TO  
CHAPTER 42F, HAWAII REVISIED STATUTES**

The undersigned authorized representative of the applicant certifies the following:

- 1) The applicant meets and will comply with all of the following standards for the award of grants pursuant to Section 42F-103, Hawaii'i Revised Statutes:
  - a) Is licensed or accredited, in accordance with federal, state, or county statutes, rules, or ordinances, to conduct the activities or provide the services for which a grant is awarded;
  - b) Complies with all applicable federal and state laws prohibiting discrimination against any person on the basis of race, color, national origin, religion, creed, sex, age, sexual orientation, or disability;
  - c) Agrees not to use state funds for entertainment or lobbying activities; and
  - d) Allows the state agency to which funds for the grant were appropriated for expenditure, legislative committees and their staff, and the auditor full access to their records, reports, files, and other related documents and information for purposes of monitoring, measuring the effectiveness, and ensuring the proper expenditure of the grant.
- 2) If the applicant is an organization, the applicant meets the following requirements pursuant to Section 42F-103, Hawaii'i Revised Statutes:
  - a) Is incorporated under the laws of the State; and
  - b) Has bylaws or policies that describe the manner in which the activities or services for which a grant is awarded shall be conducted or provided.
- 3) If the applicant is a non-profit organization, it meets the following requirements pursuant to Section 42F-103, Hawaii'i Revised Statutes:
  - a) Is determined and designated to be a non-profit organization by the Internal Revenue Service; and
  - b) Has a governing board whose members have no material conflict of interest and serve without compensation.

Pursuant to Section 42F-103, Hawaii'i Revised Statutes, for grants used for the acquisition of land, when the organization discontinues the activities or services on the land acquired for which the grant was awarded and disposes of the land in fee simple or by lease, the organization shall negotiate with the expending agency for a lump sum or installment repayment to the State of the amount of the grant used for the acquisition of the land.

Further, the undersigned authorized representative certifies that this statement is true and correct to the best of the applicant's knowledge.

Hawaii Theatre Center

\_\_\_\_\_  
(Typed Name of Individual or Organization)

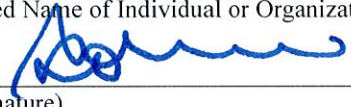

\_\_\_\_\_  
(Signature)  
Gregory D. Dunn

*1/20/2022*

\_\_\_\_\_  
(Date)  
President and Chief Executive Officer

\_\_\_\_\_  
(Typed Name)

\_\_\_\_\_  
(Title)

## Application for Grants

*If any item is not applicable to the request, the applicant should enter "not applicable".*

### **I. Certification – Please attach immediately after cover page**

#### **1. Certificate of Good Standing (If the Applicant is an Organization)**

If the applicant is an organization, the applicant shall submit one (1) copy of a certificate of good standing from the Director of Commerce and Consumer Affairs that is dated no earlier than December 1, 2021.

#### **2. Declaration Statement**

The applicant shall submit a declaration statement affirming its compliance with [Section 42F-103, Hawaii Revised Statutes](#).

#### **3. Public Purpose**

The applicant shall specify whether the grant will be used for a public purpose pursuant to [Section 42F-102, Hawaii Revised Statutes](#).

### **II. Background and Summary**

This section shall clearly and concisely summarize and highlight the contents of the request in such a way as to provide the State Legislature with a broad understanding of the request. Please include the following:

#### **1. A brief description of the applicant's background**

The historic Hawaii Theatre Center has played a significant role in Hawaii's cultural landscape since 1922, from its earliest days as a vaudeville house to its present incarnation as the state's foremost historic performance venue. With 1,400 seats, the Theatre is the second largest proscenium performance facility in the state and the only remaining theatre of its type in Hawaii. After falling into disrepair and facing demolition by a wrecking ball, a group of concerned citizens formed the nonprofit organization Hawaii Theatre Center (HTC). In order to restore this historic treasure as a world-class presentation hall, over \$32 million was raised to acquire the property under the Theatre and adjoining properties. The beautifully restored Theatre reopened in 1996 with the mission to serve arts audiences, arts organizations and the community of Hawaii by:

Preserving Hawaii's historic Hawaii Theatre

Promoting Hawaiian culture and arts

Presenting world class arts and cultural experiences

Providing arts education for Hawaii's youth

Creating a premier cultural destination at the Hawaii Theatre Center

Since 1996, HTC has served more than 2.5 million patrons of all ages, ethnicities and socio-economic backgrounds. In this past year, the Theatre has welcomed cultural programs, film screenings and other public events. HTC has continued to present performances with local, national and international performing artists.

## **2. The goals and objectives related to the request;**

The historic venue has not had a comprehensive exterior preservation treatment since 1996. As one of the earliest examples of poured concrete construction in the state, the building is ready for a significant repair and painting program that will repair areas where rusting rebar in the concrete walls will be removed, treated and then the concrete repacked. The exterior plaster surfaces will need to be removed, the concrete surface treated and plastered prior to being sealed and painted.

### **GOALS:**

1. Preserve the 100 year-old concrete historic Hawaii Theatre building for the enjoyment of future generations
2. Provide economic support to the Chinatown Community through the continuation of arts programs held at the historic Hawaii Theatre
3. Enhance exterior of the historic Hawaii Theatre, one of the state's most photographed structures and iconic neon marquee, creating a strong brand presence for the state on a global stage
4. Ensure public safety by addressing concrete spalling and chipping of plaster surfaces that are being observed on the exterior of the building

## **3. The public purpose and need to be served;**

Providing a safe, technically superb and sustainable venue for presenters and patrons will enable the Hawaii Theatre to continue to serve as the economic development catalyst for Chinatown, enhancing student learning, support of other non-profit organizations, sustain a historic landmark, and greatly enrich the lives of Hawaii residents and visitors well into the 21<sup>st</sup> century.

## **4. Describe the target population to be served; and**

The project will benefit approximately 90,000 Hawaii residents and visitors to Oahu each year, including more than 10,000 students and their families; and an average of 30-40 presenters each year who bring their events to our historic Theatre,

including non-profit arts, cultural, civic and community organizations that perform at the Theatre at greatly reduced rates.

**5. Describe the geographic coverage.**

Located in the Downtown/Chinatown Honolulu, the historic Hawaii Theatre Center's primary geographic reach is the Island of Oahu, although Theatre patrons and performing artists come from across the state to attend many of the local, national, and international shows that do not travel to the others islands. The greatest impact of the Hawaii Theatre is with individual patrons on the island of Oahu. We have a database of more than 50,000 individual patrons on Oahu and patrons found on every major Hawaiian Island, as well as the United States mainland, Japan, Germany, Korea, China, the Philippines and Europe.

**III. Service Summary and Outcomes**

The Service Summary shall include a detailed discussion of the applicant's approach to the request. The applicant shall clearly and concisely specify the results, outcomes, and measures of effectiveness from this request. The applicant shall:

1. Describe the scope of work, tasks and responsibilities;

**Project Scope:**

**Exterior Painting:** To pressure wash and paint the exterior walls, decorative columns, windows, doors, frames, railings, and metal stairs with one coat of specified primer and 2 coats of PPG Sunproof Exterior Finish. The stairwells will receive 1 coat of Amerlock Epoxy Primert and 2 coats of PPG devflex. Painting work along Bethel and Pauahi streets will require lane closures to allow for equipment access at the building exterior. Sidewalks will be closed and pedestrian and traffic control measure will be kept and maintained during the work and will be removed by the end of each shift.

**Spall Repair:** The concrete spalling on the exterior walls on Pauahi Street may be the result of having the most exposed to the weather elements including rain and wind. There may have been water intrusion issues that allow water to seep into the concrete and after a period of time, will eventually corrode the metal reinforcing within the concrete. The rust or corrosion will expand and create voids which results in the spalling issue. Repair work along Pauahi street will require lane closures to allow for equipment access at the building exterior. Sidewalks will be closed and pedestrian and traffic control measure will be kept and maintained during the work and will be removed by the end of each shift.

**Cement Plaster Repair:** There is approximately 500sf along the Pauahi Street Wall that needs to be repaired for safety reasons. In addition to the repairs of the windows, there will be sealant added to the window and door trim with Spika Flex 1a.

**Water Damage Repair:** There are number of window sill/frames that have affected by



extensive water damage and need to be replaced. Replacement sections will be profiled and matched to the existing to ensure that the historic elements are maintained.

**Bird Netting Repair:** Along the Pauahi Street wall, the current bird netting in the decorative archways and balcony balustrade have filled up with bird nests and debris that must be removed and the area treated, cleaned repairs, painted and the a new netting solution reattached to the frame.

**Bird Spikes:** To prevent further gathering of birds or other animals, bird spikes will be installed to ensure safety for all patrons, visitors and animals.

**Vertical Hawaii Signage Repair:** The stainless steel cables and steel sign attachments to the building are rusted, and are nearing the end of their useful life. After 26 years of exposure to the elements since they were last installed, these components will be evaluated for rehabilitation or replacement, and then finish painted where appropriate.

**Exterior Window Repair:** Several window sills and frames of both wood and steel construction are weather worn and required extensive repairs and then painting to ensure they are serviceable for future use. The sealants along the metal windows will be replaced to prevent water intrusion.

### **Responsibilities:**

#### **2. Provide a projected annual timeline for accomplishing the results or outcomes of the service;**

The work is anticipated to last for 5 months from the start of construction. The start of the project will depend on permit approvals.

#### **3. Describe its quality assurance and evaluation plans for the request. Specify how the applicant plans to monitor, evaluate, and improve their results; and**

- HTC staff are experienced in construction and development and will oversee the work by our General Contractor.
- The General Contractor shall provide a qualified staff to coordinate the work.
- The General Contractor may hire a historical architect as a consultant to ensure that any repair work on historic building elements is conducted in accordance with the SHPO requirements.
- Weekly status meetings will be held with the supervisor and project managers to ensure standards are maintained and any unexpected changes are reviewed prior to be approved.
- The Contractor will be paid on progress billings with completed deliverables tied to any payments.



4. List the measure(s) of effectiveness that will be reported to the State agency through which grant funds are appropriated (the expending agency). The measure(s) will provide a standard and objective way for the State to assess the program's achievement or accomplishment. Please note that if the level of appropriation differs from the amount included in this application that the measure(s) of effectiveness will need to be updated and transmitted to the expending agency.

- The spalling project will be completed and the integrity of the historic structure will be maintained
- The painting project will be completed and the visual appeal of the historic structure will be improved
- The theatre will continue to operate and the facility will remain open for use by the public

**IV. Financial**

**Budget**

1. The applicant shall submit a budget utilizing the enclosed budget forms as applicable, to detail the cost of the request.
  - a. Budget request by source of funds (Link)
  - b. Personnel salaries and wages (Link)
  - c. Equipment and motor vehicles (Link)
  - d. Capital project details (Link)
  - e. Government contracts, grants, and grants in aid (Link)
2. The applicant shall provide its anticipated quarterly funding requests for the fiscal year 2023.

Quarter 1	Quarter 2	Quarter 3	Quarter 4	Total Grant
\$500,000				\$500,000

3. The applicant shall provide a listing of all other sources of funding that they are seeking for fiscal year 2023.

Additional sources of funding that the Hawaii Theatre Center is seeking or have secured including the Shuttered Venue Operators Grant, Economic Impact Disaster Loan, Private Donations, Corporate Support and Grant funding.

4. The applicant shall provide a listing of all state and federal tax credits it has been granted within the prior three years. Additionally, the applicant shall provide a

listing of all state and federal tax credits they have applied for or anticipate applying for pertaining to any capital project, if applicable.

NOT APPLICABLE

- The applicant shall provide a listing of all federal, state, and county government contracts, grants, and grants in aid it has been granted within the prior three years and will be receiving for fiscal year 2023 for program funding.

NOT APPLICABLE

- The applicant shall provide the balance of its unrestricted current assets as of December 31, 2021.

\$9,666,737.04

## **V. Experience and Capability**

### **1. Necessary Skills and Experience**

The applicant shall demonstrate that it has the necessary skills, abilities, knowledge of, and experience relating to the request. State your experience and appropriateness for providing the service proposed in this application. The applicant shall also provide a listing of verifiable experience of related projects or contracts for the most recent three years that are pertinent to the request.

The Hawaii Theatre Center has operated successfully since it re-opened in 1996. It is a 501(c) (3) nonprofit with an annual operating budget for fiscal year 2022 - 2023 of \$1.43 million. It is operated by a full-time staff of ten and 12 part-time box office representatives and backstage production crew. It is governed by a 15-member board of directors comprised of respected business and community leaders with a wide range of expertise. The board has demonstrated a commitment to the mission of the Hawaii Theatre Center. The board is responsible for major policy decision, strategic planning, fiscal responsibility and overseeing the President and Chief Executive Officer. The current 2021 - 2022 Board of Directors include:

#### **BOARD OF DIRECTOR LISTING**

Board Position	Board Member Name	Position and Company
Board Chairperson	Timothy Howell	Managing Director, Consulting, Ernst & Young LLP
Vice Chairperson	K. Elizabeth Whitehead	Executive Vice President and Chief Administrative Officer, American Savings Bank

Vice Chairperson	L. Richard Fried	Attorney, Cronin Fried Sekiya Kekina & Fairbanks
Secretary	Cathy Lee	President and Owner, Cathy Lee Style
Treasurer	Coby Barbata	Vice President Corporate Banking Division, First Hawaiian Bank
Director	Peter Apo	President, The Peter Apo Company
Director	Jordan Brant	Senior Vice President of Leasing, Alexander
Director	Steve Colon	President Development – Hawaii Division, Hunt Companies
Director	Carol Davis	Executive Vice President of Sales and Retention, Atlas Insurance Agency
Director	Dr. Tyrie Jenkins	Ophthalmologist and Eye Surgeon, Jenkins Eye Care
Director	Marilyn Katzman	Community Volunteer
Director	Mathew Lee	Chairman and Founder, Elite Construction
Director	Don Murphy	Owner, Murphy's Bar and Grill
Director	Sarah M. Richards	Community Volunteer
Director	Ken Robbins	Partner, Bronster Fujichaku and Robbins
Director	Dr. Ligaya Stice	Pediatric Anesthesiologist, Queens Medical Center
Director	Carolyn Berry Wilson	Community Volunteer

The President and Chief Executive Officer, reports to the Board of Directors, and is responsible for all daily operations of the organization, including programs, facilities, programming, personnel and real estate.

The Theatre staff has a broad scope of skills and knowledge to administer and initiate programming and maintain the facilities. The Theatre has an exemplary history of exhibiting the capacity, skills, knowledge and experience necessary to complete major capital projects that comply with local building codes and preservation standards in a fiscally efficient and responsible manner.

Major capital improvement projects include:

- 1996 Completed \$21 million Hawaii Theatre interior restoration
- 2005 Completed \$11.5 million Hawaii Theatre exterior restoration
- 2006 Completed exterior renovation of the Theatre's Nuuanu Avenue properties

- 2009 Completed \$600,000 Hawaii Theatre roof replacement
- 2010 Completed \$1.03 million Hawaii Theatre HVAC (air conditioning) installation
- 2011 Completed sound system upgrade and cyclorama (backdrop) LED lights
- 2013 Completed the installation of a digital film projection system
- 2017 Completed the replacement of the stage lights
- 2020 Completed retrofit the interior lights and dimming system.
- 2022 Preparing to replace emergency lighting transfer system. Scheduled for completion September 2022

## **2. Facilities**

The applicant shall provide a description of its facilities and demonstrate its adequacy in relation to the request. If facilities are not presently available, describe plans to secure facilities.

In planning for the restoration and renovation of the historic Theatre, architects were very mindful of all ADA requirements. The Hawaii Theatre Center underwent a complete site survey in October 1997 by an independent third party contractor and any deficiencies were identified and corrected. The Theatre has taken special measures to insure that wheelchair and hearing disabled patrons are able to enjoy performances by providing the following services:

- Wheelchair and companion seating
- ADA signage
- Signed performances
- Infrared assisted hearing devices
- Sensitivity training for ushers

## **VI. Personnel: Project Organization and Staffing**

### **1. Proposed Staffing, Staff Qualifications, Supervision and Training**

The applicant shall describe the proposed staffing pattern and proposed service capacity appropriate for the viability of the request. The applicant shall provide the qualifications and experience of personnel for the request and shall describe its ability to supervise, train and provide administrative direction relative to the request.

#### **Gregory D. Dunn, President & Chief Executive Officer**

Gregory D. Dunn is the Hawaii Theatre Center President & Chief Executive Officer where he is responsible for ensuring Hawaii Theatre's success and future growth, including the advancement of its mission and vision and the daily action of living and promoting the Theatre's values.

Previously the President and CEO for Hawaii's Better Business Bureau (BBB), Dunn oversaw all aspects of the organization and its foundation, including the recent merger to create a larger, stronger BBB of the Northwest and the Pacific. This provides



Hawaii's 2,500 plus BBB Accredited Business members' access to a broad range of benefits and services. Prior to BBB, Dunn has worked as Vice President of Operations for Fair Horizon LLC, Executive Director of Hawaii Nature Center and the Atherton YMCA.

Dunn is a former member of the Family Programs Hawaii Board of Directors, HDS Foundation and Hawaii Dental Service, Hawaii Alliance of Non-Profit Organizations, and the Waikiki Community Center. Through his work and experience in non-profits, he received the Wallace Alexander Gerbode's Ho'okele Award for Outstanding Non-Profit Management and as a PONO Fellow of the Hawaii Community Foundation.

### **Avery Fukeda, Director of Development and Special Events**

Avery Fukeda joined the Hawaii Theatre Center in 2019 as a Development Associate and quickly promoted to the position of Development and Events Manager. Fukeda plays a significant and critical role in the fundraising efforts for the Hawaii Theatre Center by securing critical funding to support the ongoing operations and preservation of the Hawaii Theatre. He oversees a multitude of programs, including membership, annual giving, corporate sponsorship, donor relations, grant funding, young professional society, and signature events. He engages with patrons, donors and volunteers on a regular basis. He brings a decade of combined experience in fundraising, event planning/management, high-level customer service, donor relations, and stewardship.

Avery is the interim lead on the Educational Programming series and works closely with all staff, partners and vendors to ensure the series is executed and achieves benchmarks. In addition, he is serving as the Centennial Celebration Director where he will oversee all aspects and components of the Centennial for the Hawaii Theatre.

An active young professional in the community, Fukeda serves on various non-profit boards including Aloha United Society of Young Leaders (President), Hawaii Pacific University Alumni Board (President), Hawaii Foodbank Alaka'i Young Leaders Board (Board Member & Event Chair), and Make-A-Wish Hawaii Wish Granting Committee (Member).

### **Contract Positions**

#### **The CPA Collective**

This position, as an independent contractor, is held by The CPA Collective. The contractor is responsible for generating the monthly financials and balance statements of the Hawaii Theatre Center.

#### **Alan Shintani Inc.**

This position, as the General Contractor, is held by Alan Shintani Inc which worked on and restored numerous historical structures over the past 45 years of business. Projects include the restoration of the Chapel at the Royal Mausoleum in Nu'uauu, which was a complete tear down and reinstallation/restoration of the chapel, under the Service title photo is of Qtrs A, which we won various awards for restoration of the

homes built for the highest of commanders of the military order in the Pacific. We restored most of the historical homes and many buildings with-in Pearl Harbor and the Makalapa Housing area. We are often referred by the Historic Hawaii Foundation and have collaborated with them on several projects they conducted.

The general contractor will be responsible for executing the work listed in the scope of work with detail attention to the historical detail of the Theatre. In addition, the general contractor will meet with the organization's leadership for weekly meetings to provide updates and address any issues on the project.

## **2. Organization Chart**

The applicant shall illustrate the position of each staff and line of responsibility/supervision. If the request is part of a large, multi-purpose organization, include an organization chart that illustrates the placement of this request.

**SEE ATTACHMENT B**

## **3. Compensation**

The applicant shall provide an annual salary range paid by the applicant to the three highest paid officers, directors, or employees of the organization by position title, not employee name.

President and Chief Executive Officer - \$200,000

Director of Development and Special Events - \$75,000

## **VII. Other**

### **1. Litigation**

The applicant shall disclose any pending litigation to which they are a party, including the disclosure of any outstanding judgement. If applicable, please explain.

NO PENDING LITIGATION

### **2. Licensure or Accreditation**

The applicant shall specify any special qualifications, including but not limited to licensure or accreditation that the applicant possesses relevant to this request.

The historic Hawaii Theatre is listed on the State and national Historic Registers and is a member of the League of Historic American Theatres, the Association of Performing Arts Presenters, and the Hawaii Visitors and Convention Bureau.

*1997 Overall and Grant Hawaii Renaissance Award* winner from the Building industry

Association

2005 *Recognized as the Outstanding Historic Theatre in America* by the League of historic American Theatres.

2005 *Kukulu Hale Award of Excellence: Restoration Project* from the National Association of Industrial and Office Properties, Hawaii Chapter

2006 *National Preservation Honor Award* from the National Trust for Historic Preservation

2006 *Concrete Achievement Award for Concrete Structure Build Before 1940* and still in use given by the Hawaiian Cement Company

2006 *Small Nonprofit Torch Award for Business Ethics* by the Better Business Bureau of Hawaii (first recipient)

2007 Best Live Theatre by the Honolulu Star Bulletin

2018 Pineapple Awards – Attractions and Activities Winner (Pacific Business News)

### **3. Private Educational Institutions**

The applicant shall specify whether the grant will be used to support or benefit a sectarian or non-sectarian private educational institution. Please see [Article X, Section 1, of the State Constitution](#) for the relevance of this question.

Grant funds will not be used to support or benefit a sectarian or non-sectarian private educational institutions.

### **4. Future Sustainability Plan**

The applicant shall provide a plan for sustaining after fiscal year 2022-23 the activity funded by the grant if the grant of this application is:

- (a) Received by the applicant for fiscal year 2022-23, but
- (b) Not received by the applicant thereafter.

The Hawaii Theatre Center will continue its efforts in raising the necessary funds from foundations, corporations, and individuals through its annual fundraising programs. Through the generous support of the State of Hawaii Grant-In-Aid, the Hawaii Theatre Center has been able to achieve operation sustainability because the funding has allowed the Theatre to focus on attaining a break-even operation.

The renovations have allowed the Hawaii Theatre Center to increase the capacity on

the number of shows in the Theatre each year. This will allow the Theatre to keep up with the expenses. If funding is not secured, or not in the full amount, Hawaii Theatre Center may take a loan or postpone the project until funds can be raised.



## BUDGET REQUEST BY SOURCE OF FUNDS

Period: July 1, 2022 to June 30, 2023

Applicant: Hawaii Theatre Center

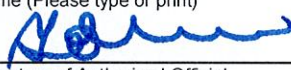
BUDGET CATEGORIES	Total State Funds Requested (a)	Total Federal Funds Requested (b)	Total County Funds Requested (c)	Total Private/Other Funds Requested (d)
A. PERSONNEL COST				
1. Salaries				
2. Payroll Taxes & Assessments				
3. Fringe Benefits				
TOTAL PERSONNEL COST				
B. OTHER CURRENT EXPENSES				
1. Airfare, Inter-Island				
2. Insurance				
3. Lease/Rental of Equipment				
4. Lease/Rental of Space				
5. Staff Training				
6. Supplies				
7. Telecommunication				
8. Utilities				
9				
10				
11				
12				
13				
14				
15				
16				
17				
18				
19				
20				
TOTAL OTHER CURRENT EXPENSES				
C. EQUIPMENT PURCHASES				
D. MOTOR VEHICLE PURCHASES				
E. CAPITAL	500,000	651,839		250,000
<b>TOTAL (A+B+C+D+E)</b>	<b>500,000</b>	<b>651,839</b>		<b>250,000</b>
<b>SOURCES OF FUNDING</b>		Budget Prepared By:		
(a) Total State Funds Requested	500,000	Gregory D. Dunn <span style="float: right;">808-791-1330</span>		
(b) Total Federal Funds Requested	651,839	Name (Please type or print) <span style="float: right;">Phone</span>		
(c) Total County Funds Requested				
(d) Total Private/Other Funds Requested	250,000	Signature of Authorized Official <span style="float: right;">Date</span>		
		1/20/2022		
<b>TOTAL BUDGET</b>	<b>1,401,839</b>	Gregory D. Dunn, President and CEO Name and Title (Please type or print)		



# BUDGET JUSTIFICATION - EQUIPMENT AND MOTOR VEHICLES

Period: July 1, 2022 to June 30, 2023

Applicant: Hawaii Theatre Center

DESCRIPTION EQUIPMENT	NO. OF ITEMS	COST PER ITEM	TOTAL COST	TOTAL BUDGETED
PROJECT MANAGEMENT & SUPERVISION	SEE ATTACHMENT A FOR DETAILS		\$ 421,033.00	421033
SAFETY, CLEANUP AND PROTECTION	SEE ATTACHMENT A FOR DETAILS		\$ 19,780.00	19780
CONCRETE REHABILITATION	SEE ATTACHMENT A FOR DETAILS		\$ 215,000.00	215000
SIGN REPAIR	SEE ATTACHMENT A FOR DETAILS		\$ 9,896.00	9896
CAPENTRY	SEE ATTACHMENT A FOR DETAILS		\$ 98,048.00	98048
PAINTING AND COVERINGS	SEE ATTACHMENT A FOR DETAILS		\$ 577,700.00	577700
BIRD SPIKES	SEE ATTACHMENT A FOR DETAILS		\$ 9,620.00	9620
OTHER PROJECT PROGRAMS INCLUDING BOND, INSURA	SEE ATTACHMENT A FOR DETAILS		\$ 52,762.00	52762
	SEE ATTACHMENT A FOR DETAILS		\$ -	
	SEE ATTACHMENT A FOR DETAILS		\$ -	
	SEE ATTACHMENT A FOR DETAILS		\$ -	
TOTAL:			\$ 1,403,839.00	1,403,839
JUSTIFICATION/COMMENTS:				

DESCRIPTION OF MOTOR VEHICLE	NO. OF VEHICLES	COST PER VEHICLE	TOTAL COST	TOTAL BUDGETED
NOT APPLICABLE			\$ -	
			\$ -	
			\$ -	
			\$ -	

# BUDGET JUSTIFICATION - EQUIPMENT AND MOTOR VEHICLES

Period: July 1, 2022 to June 30, 2023

			\$	-
TOTAL:				
JUSTIFICATION/COMMENTS:				



# BUDGET JUSTIFICATION - CAPITAL PROJECT DETAILS

Period: July 1, 2022 to June 30, 2023

Applicant: Hawaii Theatre Center

FUNDING AMOUNT REQUESTED						
TOTAL PROJECT COST	ALL SOURCES OF FUNDS RECEIVED IN PRIOR YEARS		STATE FUNDS REQUESTED	OTHER SOURCES OF FUNDS REQUESTED	FUNDING REQUIRED IN SUCCEEDING YEARS	
	FY: 2020-2021	FY: 2021-2022	FY: 2022-2023	FY: 2022-2023	FY: 2023-2024	FY: 2024-2025
PLANS						
LAND ACQUISITION						
DESIGN						
CONSTRUCTION	0	0	1401839	0	0	0
EQUIPMENT						
<b>TOTAL:</b>			<b>1,401,839</b>			
<b>JUSTIFICATION/COMMENTS:</b> See attachment A for construction details. This is a critical project that will ensure the integrity of the exterior of the Hawaii Theatre and ensure safety for future visitors and patrons.						

**GOVERNMENT CONTRACTS, GRANTS, AND / OR GRANTS IN AID**

Applicant: Hawaii Theatre Center

Contracts Total: 973,589

	<b>CONTRACT DESCRIPTION</b>	<b>EFFECTIVE DATES</b>	<b>AGENCY</b>	<b>GOVERNMENT ENTITY (U.S./State/Hawaii/ Honolulu/ Kauai/ Maui County)</b>	<b>CONTRACT VALUE</b>
1	pARTners for the Arts 2021 - 2022	07/01/2021 to 02/28/2022	State Foundation on Culture and the Arts	State of Hawaii	15,000
2	A Portion of Interior and Exterior Lighting Replacement	TBD	Department of Accounting and General Services	State of Hawaii	100,000
3	A Portion of Interior and Exterior Lighting Replacement	7/25/2018 to 7/31/2019	Department of Accounting and General Services	State of Hawaii	500,000
4	Educational Programming	7/1/2018 to 5/31/2019	State Foundation on Culture and the Arts	State of Hawaii	5,550
5	Educational Programming	7/1/2017 to 6/30/2018	State Foundation on Culture and the Arts	State of Hawaii	3,062
6	Stage Lighting Replacement	4/27/2017 to 12/31/2018	Department of Accounting and General Services	State of Hawaii	300,000
7	Educational Programming	7/1/2016 to 6/30/2017	State Foundation on Culture and the Arts	State of Hawaii	5,315
8	Educational Programming	7/1/2015 to 6/30/2016	State Foundation on Culture and the Arts	State of Hawaii	2,263
9	Educational Programming	7/1/2014 to 6/30/2015	State Foundation on Culture and the Arts	State of Hawaii	2,399
10	Hawai iTheatre Center's 2015 Hana Hou! Season	1/1/2015 to 12/31/2015	Hawaii Tourism Authority	State of Hawaii	20,000
11	Hawai iTheatre Center's 2014 Hana Hou! Season	1/1/2014 to 12/31/2014	Hawaii Tourism Authority	State of Hawaii	20,000
12					
13					
14					
15					
16					



**Price Summary**

Hawaii Theatre Exterior Repairs & Painting  
1/12/2022

Description	Total	% of Tot.
<b>DIVISION 1 - GENERAL REQUIREMENTS</b>	<b>\$117,780</b>	<b>8.40%</b>
Project Management & Supervision	\$98,000	6.99%
Safety, Cleanup & Protection	\$19,780	1.41%
<b>DIVISION 3 - CONCRETE</b>	<b>\$215,000</b>	<b>15.34%</b>
Concrete Rehabilitation	\$215,000	15.34%
<b>DIVISION 5 - METALS</b>	<b>\$9,896</b>	<b>0.71%</b>
Sign Repair	\$9,896	0.71%
<b>DIVISION 6 - WOOD, PLASTIC &amp; COMPOSITES</b>	<b>\$96,048</b>	<b>6.85%</b>
Carpentry	\$96,048	6.85%
<b>DIVISION 9 - FINISHES</b>	<b>\$577,700</b>	<b>41.21%</b>
Painting & Coverings	\$577,700	41.21%
<b>DIVISION 10 - SPECIALTIES</b>	<b>\$9,620</b>	<b>0.69%</b>
Bird spikes	\$9,620	0.69%
<b>Subtotal</b>		<b>73.19%</b>
Contractor Bond	\$10,513	0.75%
Insurance	\$14,018	1.00%
Gross Excise Tax	\$28,231	2.01%
<b>Total Cost</b>		<b>76.96%</b>
10% Contingency	\$140,184	10.00%
Overhead & Profit	\$182,849	13.04%
<b>Total Price</b>		<b>100.00%</b>

Prices are good for 30 days from above date.

ALAN SHINTANI, INC.

Robert de los Reyes  
Vice President



**Scope of work**

- 1 Pressure wash and paint building exterior, one prime, two finish.
- 2 Repair spalls approximately 500sf concrete substrate wall along Pauahi Street elevation.
- 3 Patch existing cement plaster, approximately 500sf along Pauahi Street elevation
- 4 Repair existing water damaged window sill or frame.
- 5 Remove and reinstall existing bird netting to accommodate painting work
- 6 Clean existing bird debris.
- 7 Install new stainless steel bird spikes.
- 8 Replace existing rusted hardware at vertical Hawaii signage.
- 9 Seal and paint existing metal windows.

**GENERAL NOTES:**

- 1 No work included at existing Marquee Sign.
- 2 Painting includes exterior walls, decorative columns, windows, doors, frames, railings, and metal stairs.
- 3 Painting of concrete, plaster walls, and wood trims with 1 coat of specified primer and 2 coats of PPG Sunproof Exterior Finish.
- 4 Painting of metal stairs with 1 coat of Amerlock Epoxy Primert and 2 Coats of PPG Devflex.
- 5 Sealing of window and door trim to wall with Sika Flex 1a.



**EXCLUDED:**

- 1 Unforeseen conditions.
- 2 Builders Risk Insurance.
- 3 Architectural design and all consultant fees.
- 4 Application, fee, and routing for building permit, including change order work or other revisions made to the Contract Documents or to the Building Department approved set of plans.
- 5 Environmental documentation.
- 6 Monitoring, handling, abatement or removal of toxic and hazardous materials, (including contaminated soils or water).
- 7 Historical architect/review/submittal to SHPO.
- 8 Any work on the existing marquee sign
- 9 Any work on the existing canopy.

**GENERAL NOTES:**

- 1 Proposal is based upon reaching mutually agreeable Contract terms and conditions.
- 2 Breakdowns by phase or area are for informational or accounting purposes only and can't be accepted separately.
- 3 ASI to provide as-built drawings at end of the project. Record drawings are not required.
- 4 ASI will be allowed to stage equipment at the Park, with permission from the City and County and by the Client.
- 5 Lane closures will be coordinated with the Client.



AREA OF RENOVATION WORK  
CONCRETE REPAIR WORK AND REPAINTING WORK

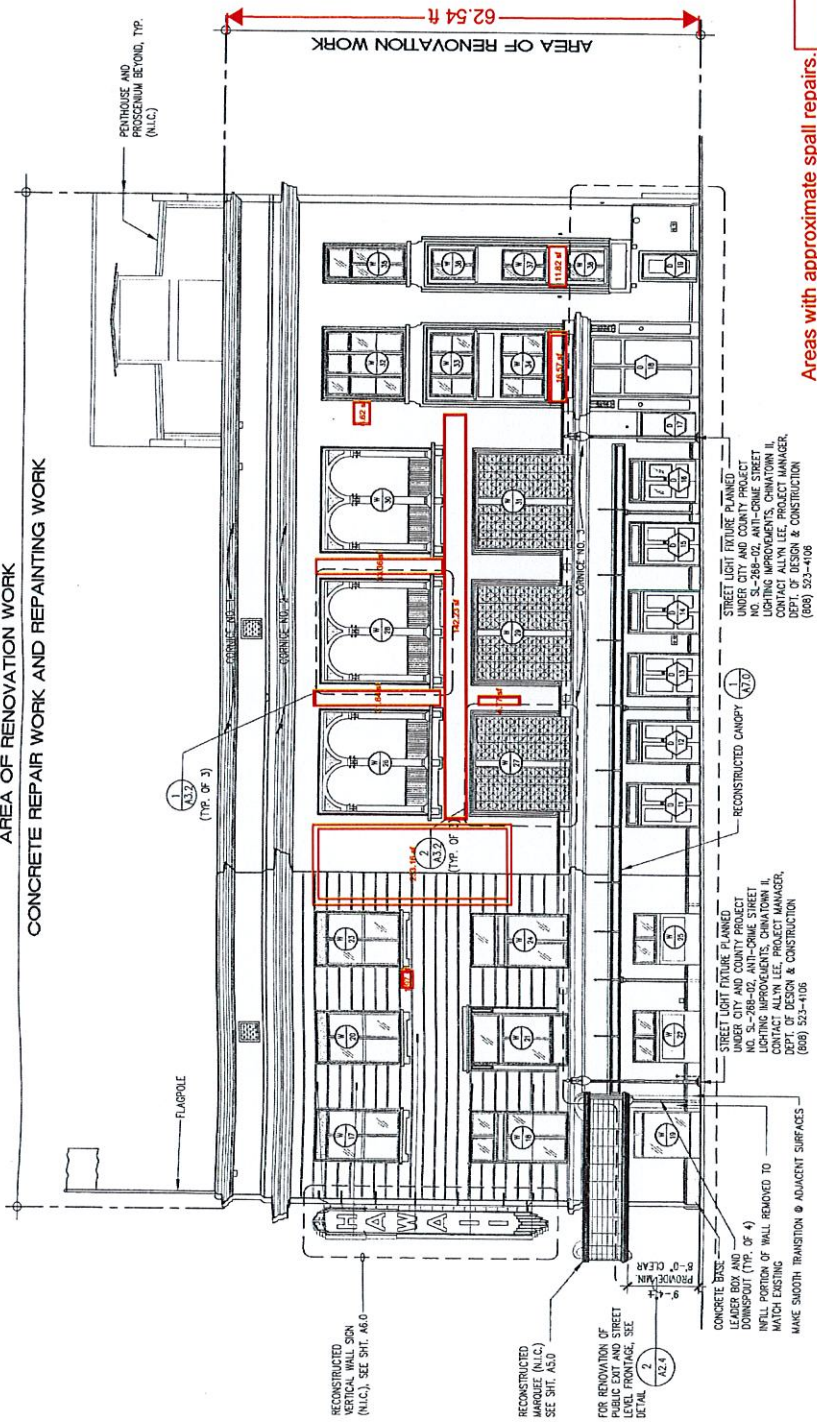

Areas with approximate spall repairs.  
Field verify.

NOTE:  
1. ALL CONCRETE AND PLASTER FINISHES BELOW CORNICE #3 SHALL BE PAINTED W/ ANTI-GRAFFITI PAINT U.O.N.

1  
A2.3  
PAUHAHI STREET EXTERIOR ELEVATION (REFER TO EXTERIOR RENOVATION - GENERAL NOTES, SHT. A2.2)  
SCALE: 1/8" = 1'-0"



# Hawaii Theatre Center

## Exterior Painting and Repair Organization Chart (Attachment B)

